

# CARLISLE PUBLIC SKATEPARK

NORTH VIEW

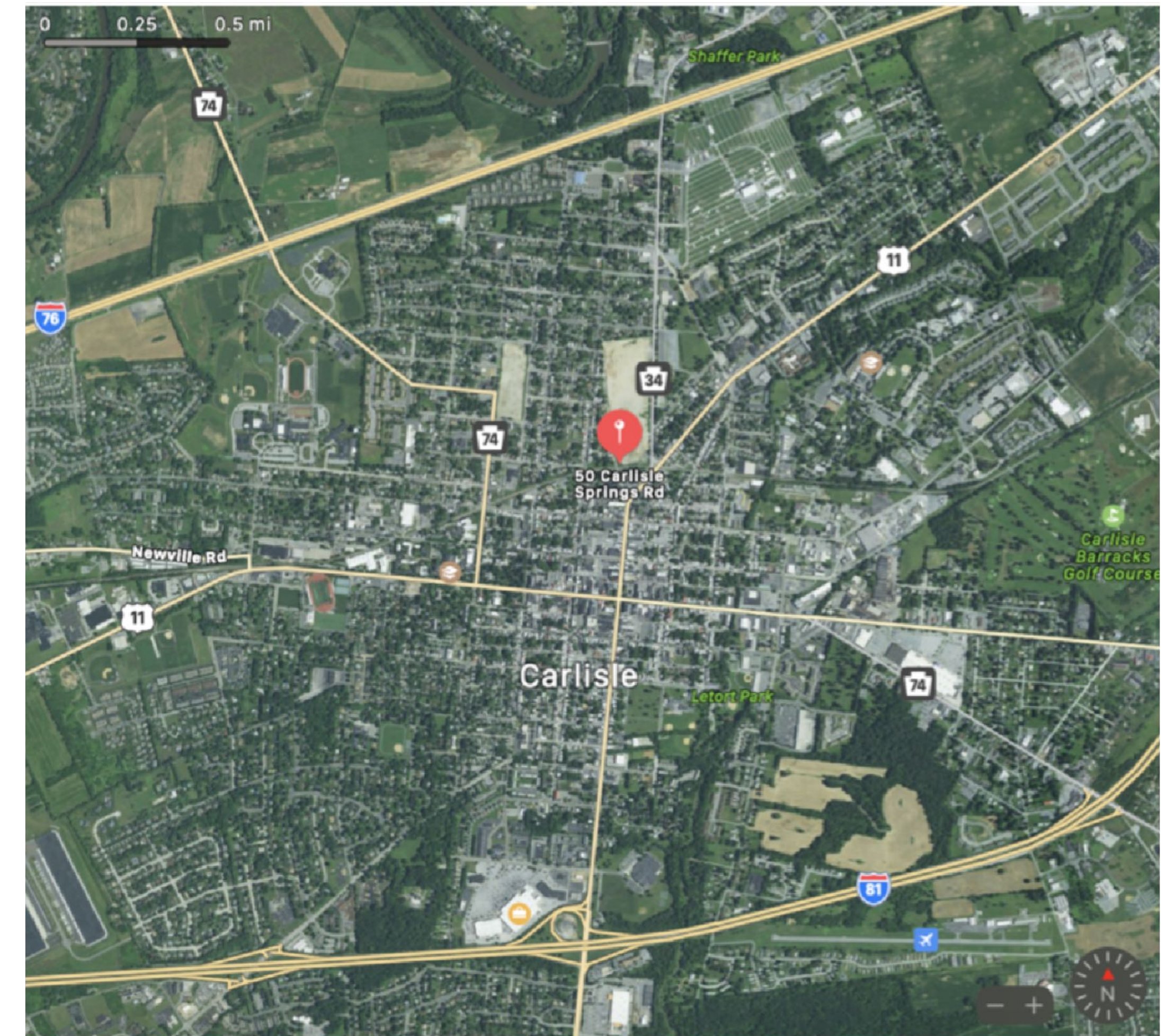

**PROJECT LOCATION:  
50 CARLISLE SPRINGS RD  
CARLISLE, PA 17013**

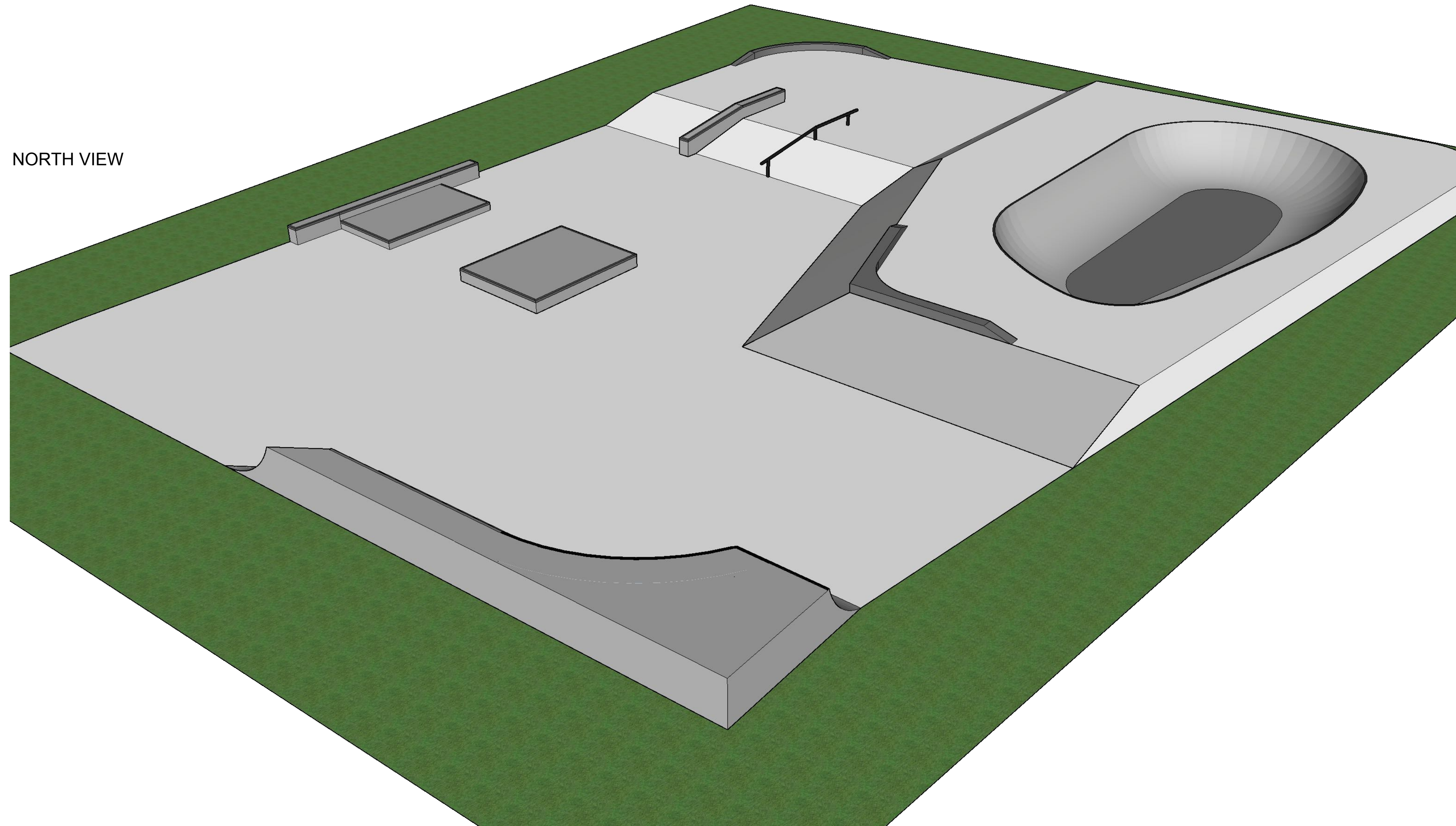
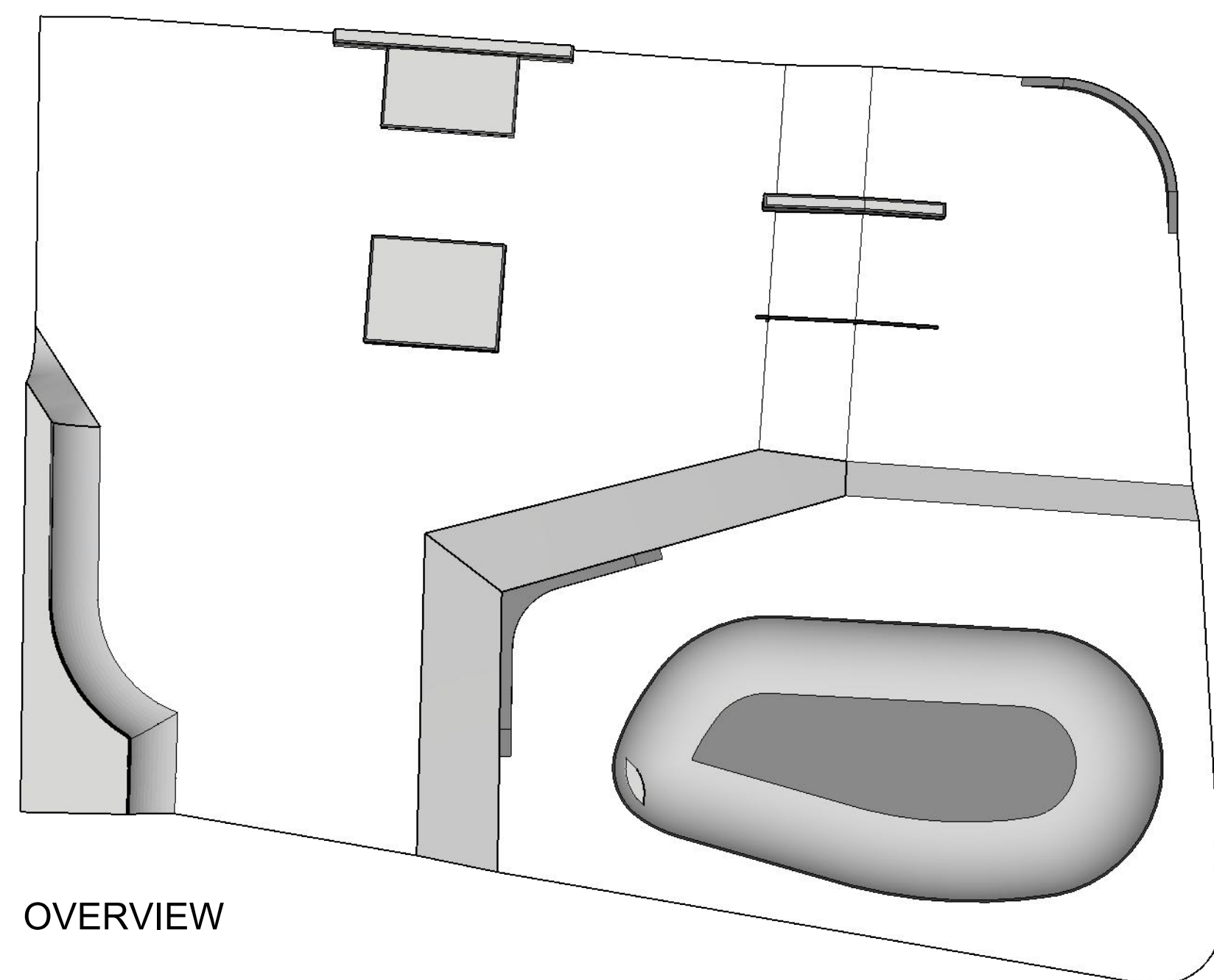

OVERVIEW

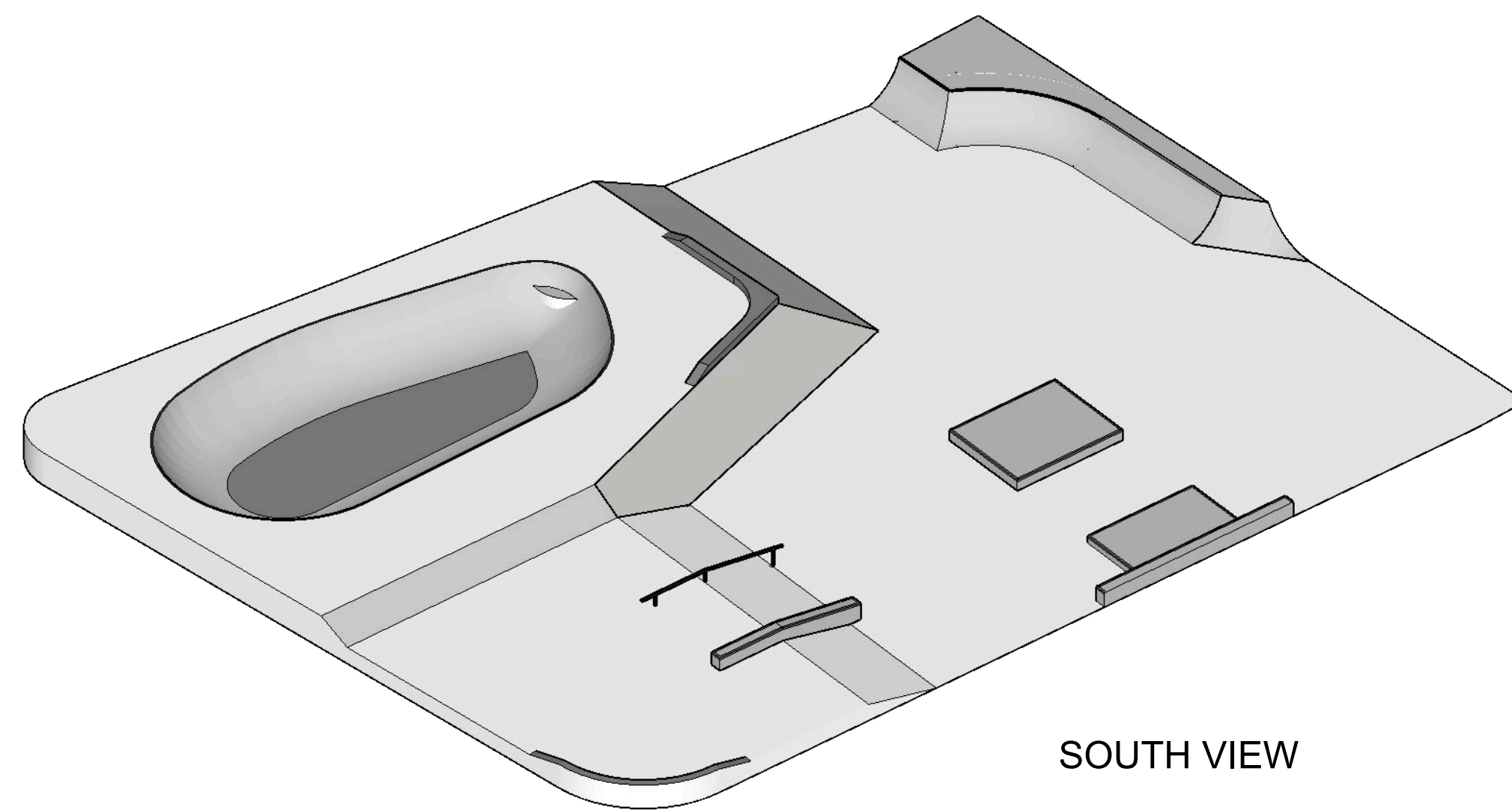

SOUTH VIEW

- NDEX:**
- P1- OVERALL DIMENSIONS, NOTES, SCOPE, SPECS, FEATURES
  - P2- L.O.D., SOIL EROSION, DRAINAGE, ELEVATIONS
  - P3- LEDGE, RAIL DETAIL
  - P4- BOWL, TRANSITION AND BANK DETAIL
  - P5- QUARTERPIPE W/ BOWL CORNER, TWO HIPS. PERIMETER WALL
  - P6- COLD JOINT, REBAR SCHEDULE, DRAIN DETAIL, FENCING, SIGNAGE



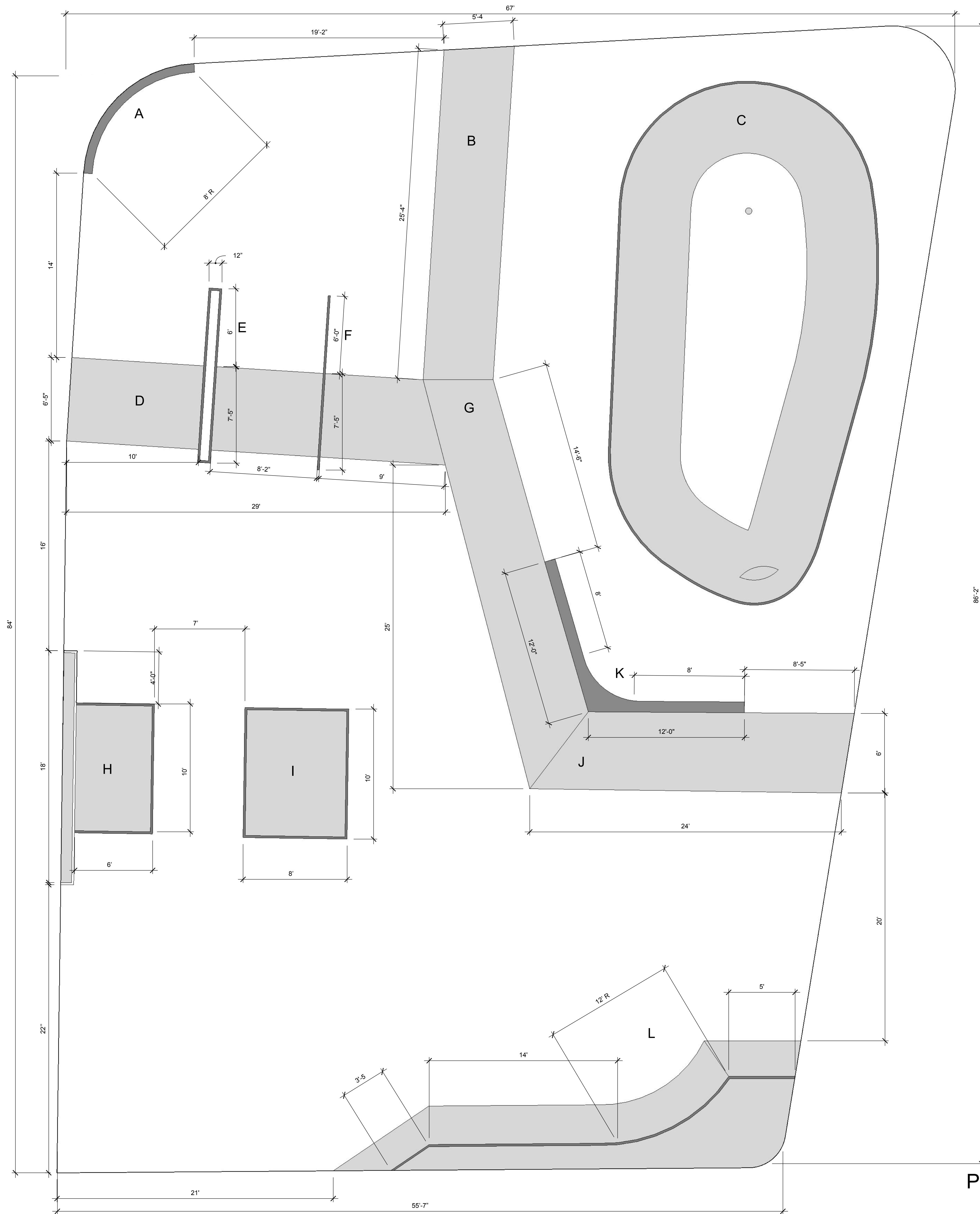

**GENERAL NOTES:**

DUE TO COMPLEXITY OF LOT LAYOUT, OVERALL MEASUREMENTS WILL NEED TO BE FIELD VARIFIED BY CONTRACTOR.

1. ALL WORK SHALL CONFORM TO THE 2022 BUILDING CODE, RULES AND REGULATIONS. PROJECTS IN THE CITY OF CARLISLE SHALL CONFORM TO THE 2022 BUILDING CODES.

2. CONTRACTOR TO VERIFY ALL DIMENSION DATUMS AND LEVELS PRIOR TO CONSTRUCTION. ALL DIMENSIONS ARE TO FACE OF CONCRETE UNLESS NOTED OTHERWISE. DO NOT SCALE DRAWINGS FOR CRITICAL DIMENSIONS.

3. CONTRACTOR SHALL BE RESPONSIBLE FOR ALL REQUIRED SAFETY PRECAUTIONS AND THE METHODS, TECHNIQUES, SEQUENCES OR PROCEDURES REQUIRED TO PERFORM THE WORK.

4. DO NOT SIGNIFICANTLY VARY OR MODIFY THE WORK SHOWN WITHOUT WRITTEN INSTRUCTIONS FROM THE ARCHITECT, ENGINEER AND CITY OF CARLISLE.

5. REPORT ERRORS AND OMISSIONS TO THE ENGINEER IMMEDIATELY.

6. THESE DRAWINGS ARE THE PROPERTY OF CARLISLE BOROUGH AND MAY BE REPRODUCED ONLY WITH WRITTEN PERMISSION. AUTHORIZED REPRODUCTIONS MUST BEAR THE NAME AND SIGNATURE OF THE CARLISLE BOROUGH.

7. WORKING DRAWINGS BY THEIR VERY NATURE ARE DIAGRAMMATIC AND DO NOT PROVIDE ALL DETAILS OR CONDITIONS OF CONSTRUCTION. HOWEVER, QUESTIONS MAY ARISE AS TO THE DESIGN INTENT AND TO CONSTRUCTION TECHNICAL DETAILING WITHIN THESE DRAWINGS. AS CLARIFICATIONS, INTERPRETATIONS, AND REVISIONS ARE PART OF THE CONSTRUCTION PROCESS, ARMENT CONCRETE LLC SHALL NOT BE LIABLE FOR ANY DIRECT, INDIRECT OR CONSEQUENTIAL DAMAGES AS A RESULT OF NOT PARTICIPATING IN THE CONSTRUCTION PROCESS.

**SCOPE OF WORK:**

NO ADMITTANCE TO CONSTRUCTION ZONE BY PEDESTRIANS. SKATEPARK FEATURES TO BE CONSTRUCTED IN A TIMELY MANNER. ESTIMATED TIMELINE FROM START TO FINISH IS 90 WORKING DAYS, WEATHER PERMITTING. ALL MATERIALS SHALL BE STORED OR KEPT ON SKATEPARK LOT, NOT IN SURROUNDING PARK AREA. CONSTRUCTION ZONE TO BE FENCED IN DURING CONSTRUCTION. CONCRETE STRUCTURES TO BE INSTALLED BY SKATEPARK CONCRETE PROFESSIONALS ONLY, TO THE SPECIFICATIONS DESIGNATED IN PRINT AND APPROVED BY FREDERICK, SEIBERT & ASSOCIATES, INC. LANDSCAPING OUTSIDE OF THE SKATE PARK FACILITY IS THE RESPONSIBILITY OF THE CHOSEN CONTRACTOR. AREAS BEHIND RAISED FEATURES MAY BE FINISHED WITH DECORATIVE LANDSCAPE BLOCK OR TOP SOIL W/GRASS SEED. FINAL CLEANUP AND PARK INSPECTION NECESSARY FOR FINAL PAYMENT. SKATEPARK SIGNAGE AND INSURANCE WILL BE THE SOLE RESPONSIBILITY OF THE CARLISLE BOROUGH. ANY CHANGE ORDERS TO THE ORIGINAL DRAWING MUST BE SUBMITTED IN WRITING AND APPROVED BY THE CARLISLE BOROUGH.

**SPECIFICATIONS:**

**CONCRETE:**  
 ALL SKATEPARK FEATURE CONCRETE TO BE POURED WITH 4,000 PSI w/ 3% AIR ENTRAINMENT, 1/2" STONE AGGREGATE, INSTALLED AT A 4" slump. ALL FEATURES TO BE POURED MONOLITHIC, NO LESS THAN 5" THICK ON CLEAN, COMPACTED SUBGRADE. 3/8" REBAR, 24" O.C. CONTINUOUS. RADIUS SCREEDS ARE TO BE USED WHERE SPECIFIC RADIUS ARE CALLED FOR IN PRINT. ALL SURFACE CONCRETE TO BE POURED 4,000 PSI w/ 3% AIR ENTRAINMENT, 1/2" STONE AGGREGATE POURED AT A 4" slump. ALL SLABS TO BE POURED AFTER SKATEPARK FEATURES. ALL SLABS TO BE AT LEAST 4" THICK ON TOP OF 4" COMPACTED 3/4" STONE BASE. 3/8" REBAR, 24" O.C. CONTINUOUS. DRAIN IN BOWL AREA DETAIL TO BE 6" CAST IRON OR BRASS PLUMBED TO THE INFILTRATION TRENCH. EXPANSION JOINTS TO BE CUT EVERY 200 SQUARE FEET WHERE APPLICABLE.  
 COLD JOINTS MUST CO-JOIN POURS WITH 1/2"x18" SMOOTH DOWEL REBAR 18" O.C. 8" THICKENED EDGE REQUIRED AT ALL COLD JOINT AREAS. ALL SURFACES TO BE TROWELED USING HARD STEEL TROWELS WITH MINIMUM WATER. VAPOR AID OR AQUAFILM IS RECOMMENDED DURING THE FINISHING PROCESS. COPING IS TO BE EDGED USING A 1/8" EDGING TOOL. RADIUS COPING IS TO BE INSTALLED IN A MANNER THAT LEAVES CONSISTENT CURVES WITHOUT KINKS. PERIMETER SLABS TO BE EDGED USING A 3/4" EDGING TOOL. WATER BASED CURE AND SEAL AGENT TO BE APPLIED TO ALL CONCRETE SURFACES.

**FEATURES:**

- A- RADIUS CURB 1
- B- TRANSITIONAL EMBANKMENT 1
- C- BOWL
- D- TRANSITIONAL EMBANKMENT 2
- E- HUBBA/FLAT LEDGE
- F- FLATBAR/DOWNRAIL
- G- HIP EMBANKMENT 1
- H- TIER LEDGE
- I- BOX LEDGE
- J- HIP EMBANKMENT 2
- K- RADIUS CURB 2
- L- 3'X21' QUARTERPIPE WITH HIP

P1- OVERALL DIMENSIONS, NOTES, SCOPE, SPECS, FEATURES



**COMPANY:**  
 Arment Concrete  
 PO Box 43 DENVER, PA  
 MATT@ARMENTCONCRETE.COM

**CLIENT:**  
 CARLISLE BOROUGH  
 53 W. SOUTH STREET  
 CARLISLE PA 17013

**ISSUE:**  
 12/20/2021

**PROJECT NO.:**  
 1/1/22-01  
**PROJECT:**  
 Carlisle Skatepark

**ENGINEER:**  
 FREDERICK, SEIBERT &  
 ASSOCIATES, INC.  
 128 S POTOMAC ST  
 HAGERSTOWN, MD 21740  
 (301) 791-3650







**COMPANY:**  
Arment Concrete  
PO Box 43 DENVER, PA  
MATT@ARMENTCONCRETE.COM

**CLIENT:**  
CARLISLE BOROUGH  
53 W. SOUTH STREET  
CARLISLE PA 17013

**ISSUE:**  
12/20/2021

**PROJECT NO.:**  
1/1/22-01

**PROJECT:**  
Carlisle Skatepark

**ENGINEER:**  
FREDERICK, SEIBERT &  
ASSOCIATES, INC.  
128 S POTOMAC ST  
HAGERSTOWN, MD 21740  
(301) 791-3650

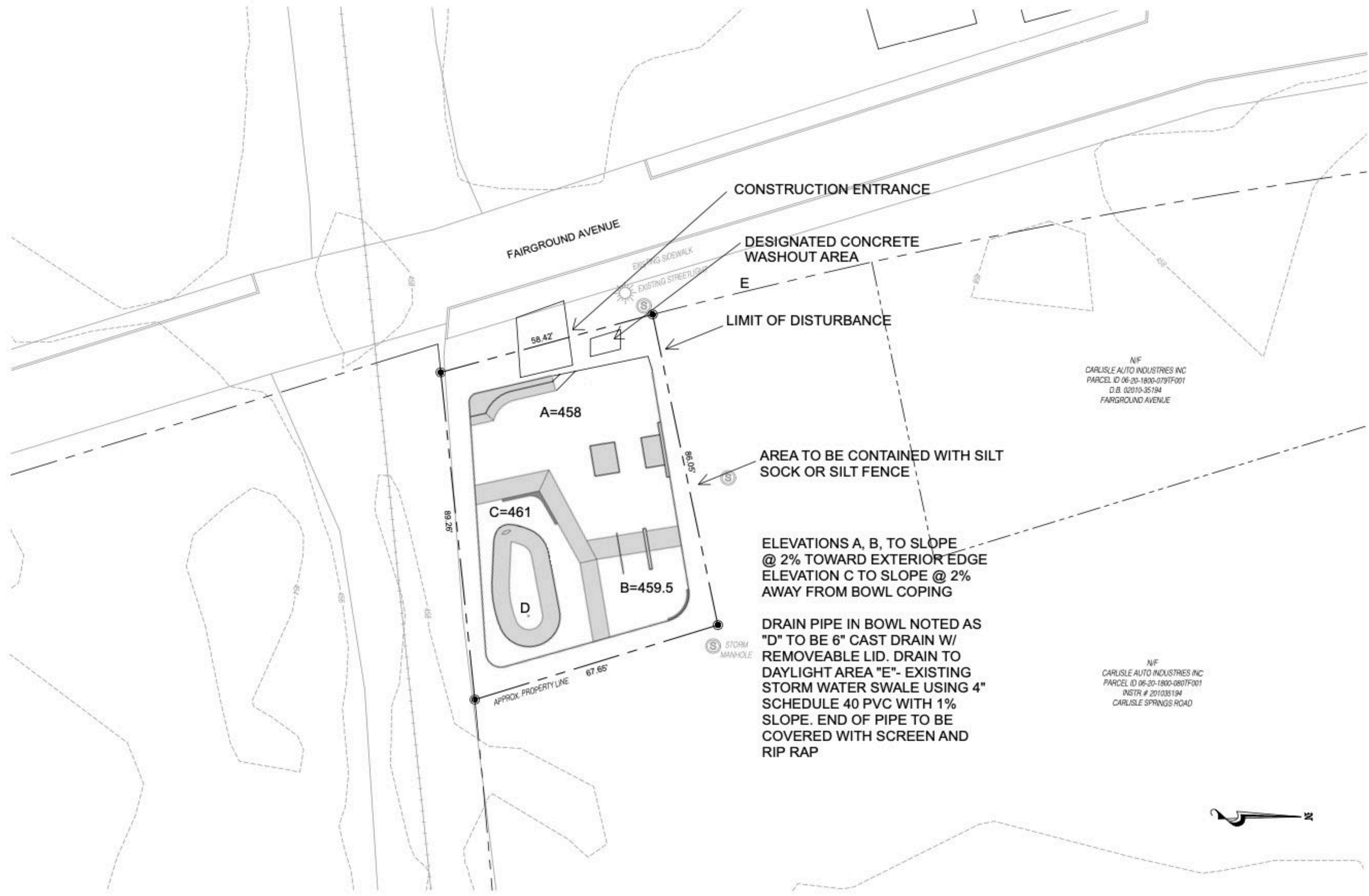

\*DRAWING NOT TO SCALE



### A- RADIUS CURB 1

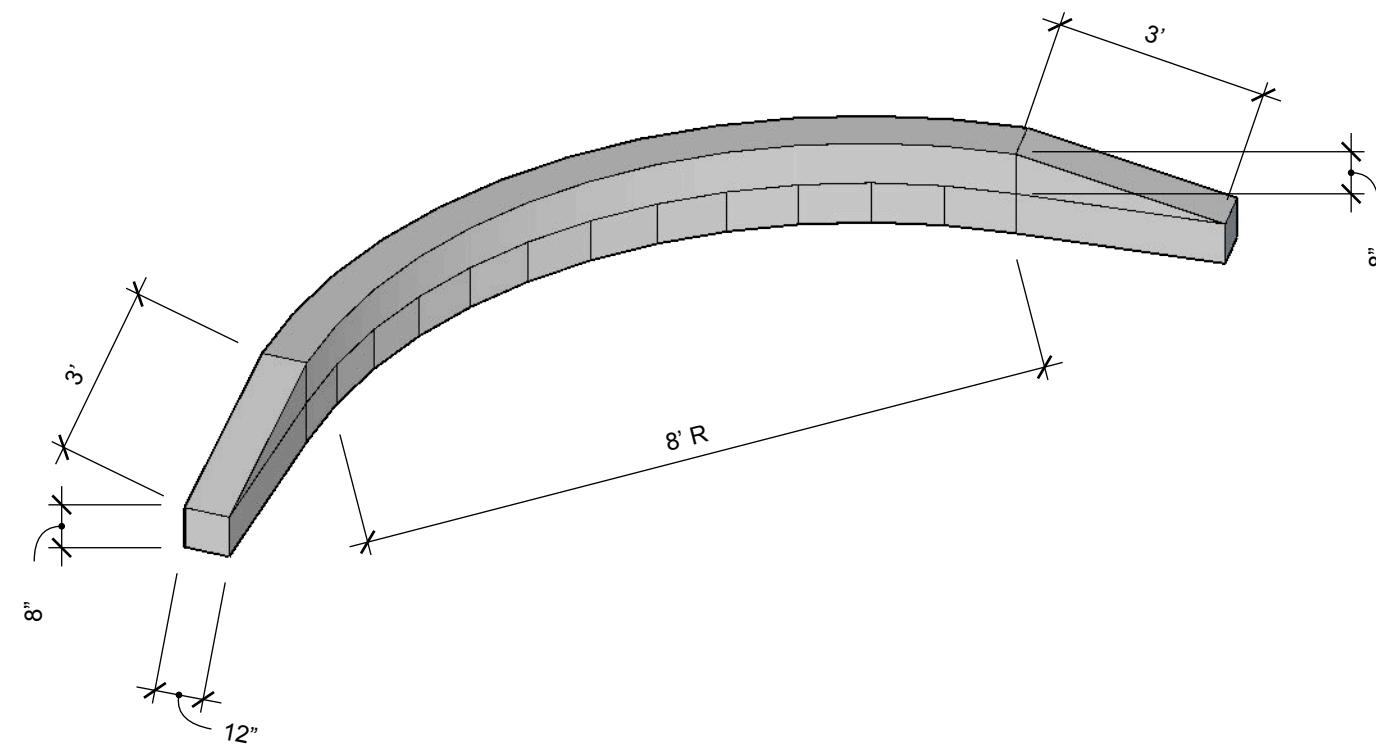

CURB TO BE POURED MONOLITH, FORMED WITH FLEX FORMS. EDGES OF EXPOSED CONCRETE TO BE EDGED USING 1/2" EDGING TOOL. FACES ARE TO BE RUBBED WITH A SPONGE. AS NOTED IN DRAWING THERE IS TO BE AN 8" EXPOSED FACE. TOP OF CURB TAPERS IN 3' TO MEET SLAB GRADE.

### E- HUBBA/FLAT LEDGE

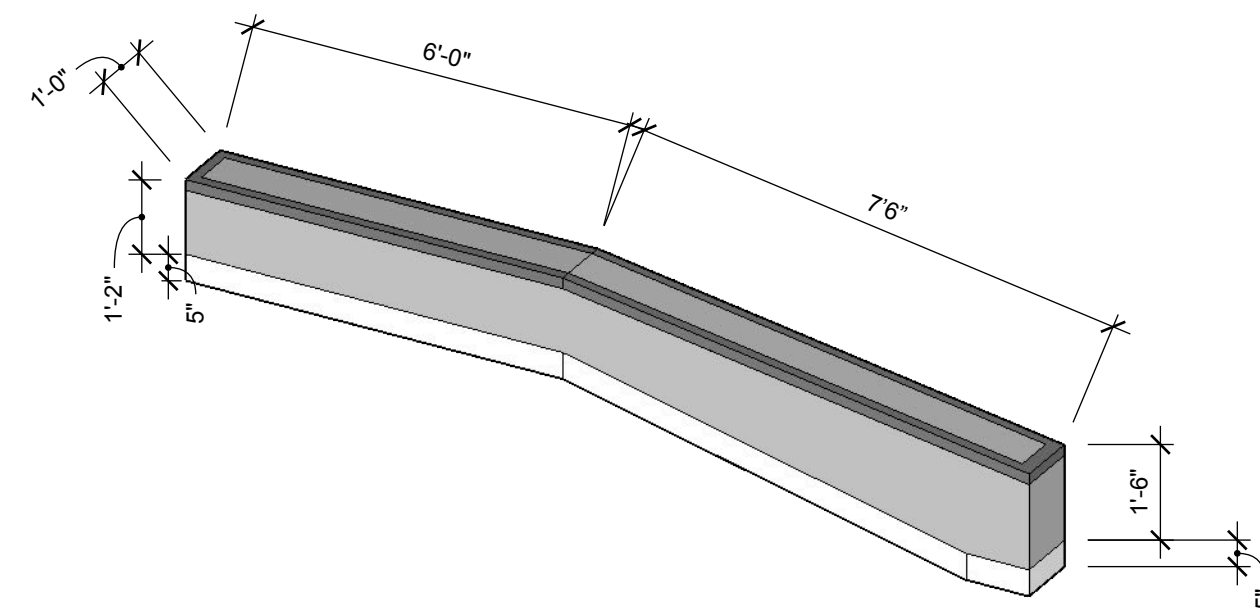

HUBBA TO BE POURED MONOLITH, FORMED WITH STRAIGHT FORMS. EDGES OF EXPOSED CONCRETE TO RECIEVE 2"X2" STEEL EDGING WITH MUD HOOKS WELDED EVERY 12". FACES ARE TO BE RUBBED WITH A SPONGE. AS NOTED IN DRAWING THERE IS TO BE AN 14" EXPOSED FACE ON TOP 6' AND SLOPE SO THAT THERE IS AN 18" DROP OF THE LOWER END OF THE LEDGE. 5" OF LEDGE TO BE FOOTING.

### F- FLAT BAR/DOWN RAIL

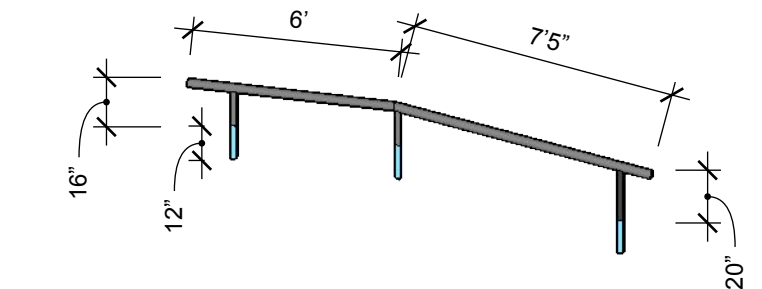

FLAT BAR/DOWN RAIL TO BE WELDED SECURELY TO 3 OR MORE DOWN-POSTS AT LEAST 12" OF DOWN-POSTS MUST BE BURIED IN CONCRETE FOOTER (AREA SHOWN IN BLUE IN DRAWING) ALL SEAMS TO BE GROUND SMOOTH AFTER WELDING AND ALL STEEL TO BE PAINTED. ALL STEEL TO BE 2" NON GALVANIZED. TOP SECTION OF FLAT BAR TO BE 16" ABOVE CONCRETE SLAB AND LOWER SECTION TO BE 20" ABOVE SLAB.

### H- TIER LEDGE

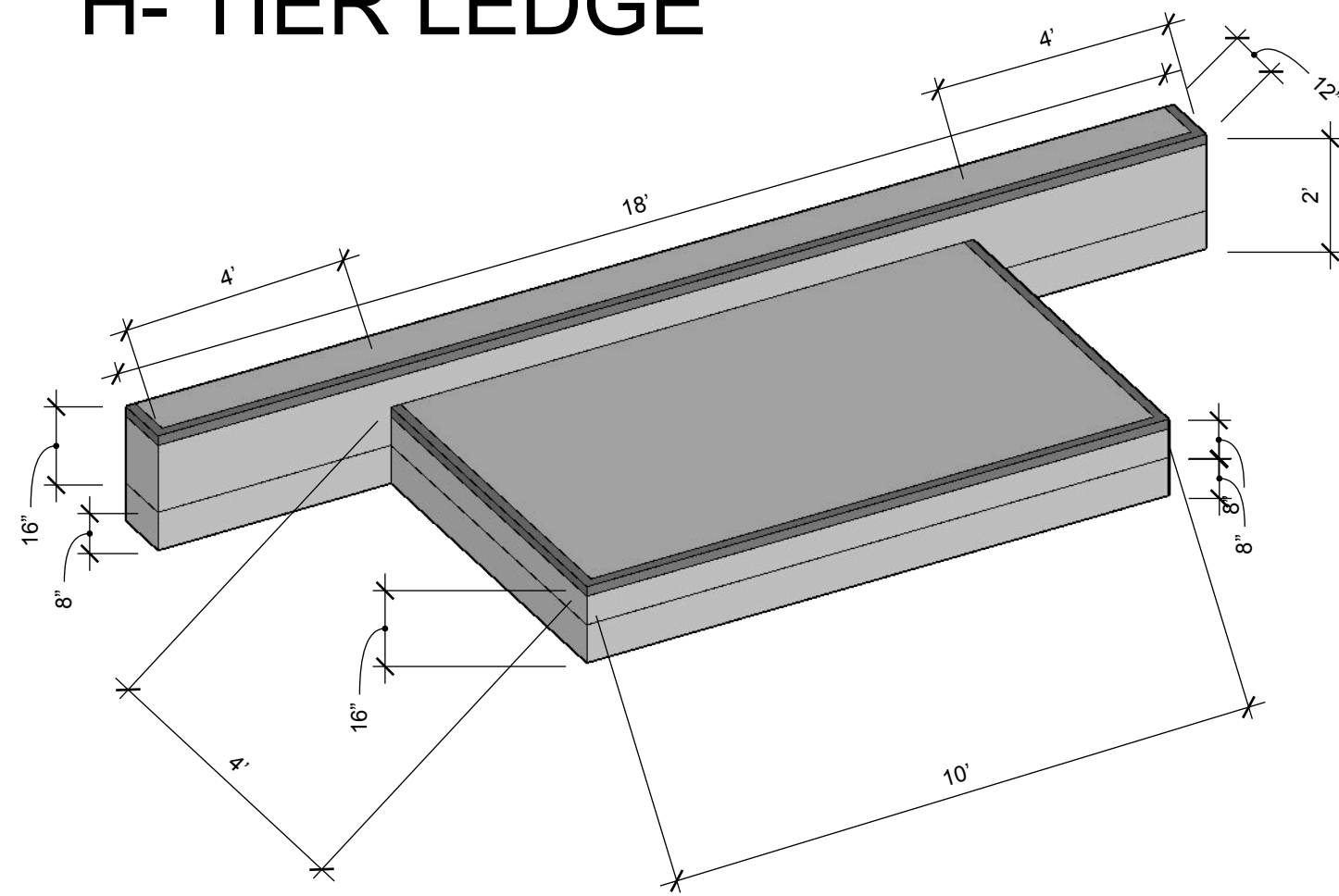

REAR SECTION OF LEDGE (18'X1'X2') IS TO BE POURED PRIOR TO LOWER (8'X10') SECTION, WITH 16" OF FACE EXPOSED ABOVE SLAB, MIN OF 8" FOOTER. LOWER PAD TO HAVE 8" OF FACE EXPOSED ABOVE SLAB, MIN OF 8" FOOTER. EDGES OF EXPOSED CONCRETE TO RECIEVE 2"X2" STEEL EDGING WITH MUD HOOKS WELDED EVERY 12". FACES ARE TO BE RUBBED WITH A SPONGE TO YEILD CONSISTENT TEXTRUE. TOP TO BE TROWELD SMOOTH.

### I- BOX LEDGE

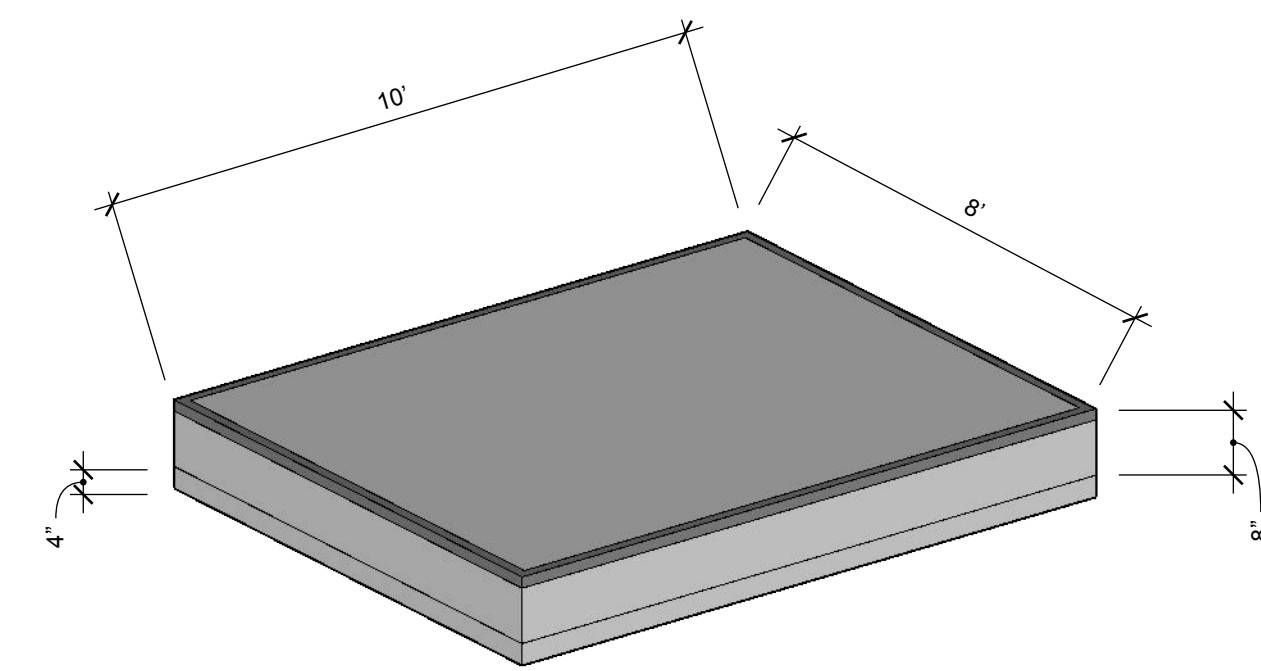

BOX LEDGE TO BE POURED MONOLITH, FORMED WITH STRAIGHT FORMS. EDGES OF EXPOSED CONCRETE TO RECIEVE 2"X2" STEEL EDGING WITH MUD HOOKS WELDED EVERY 12". AS NOTED IN DRAWING, THERE IS TO BE A 12" EXPOSED FACE AND 4" FOOTER UNDER SLAB. FACES ARE TO BE RUBBED WITH A SPONGE TO YEILD CONSISTENT TEXTRUE. TOP TO BE TROWELD SMOOTH.

### K- RADIUS CURB 2

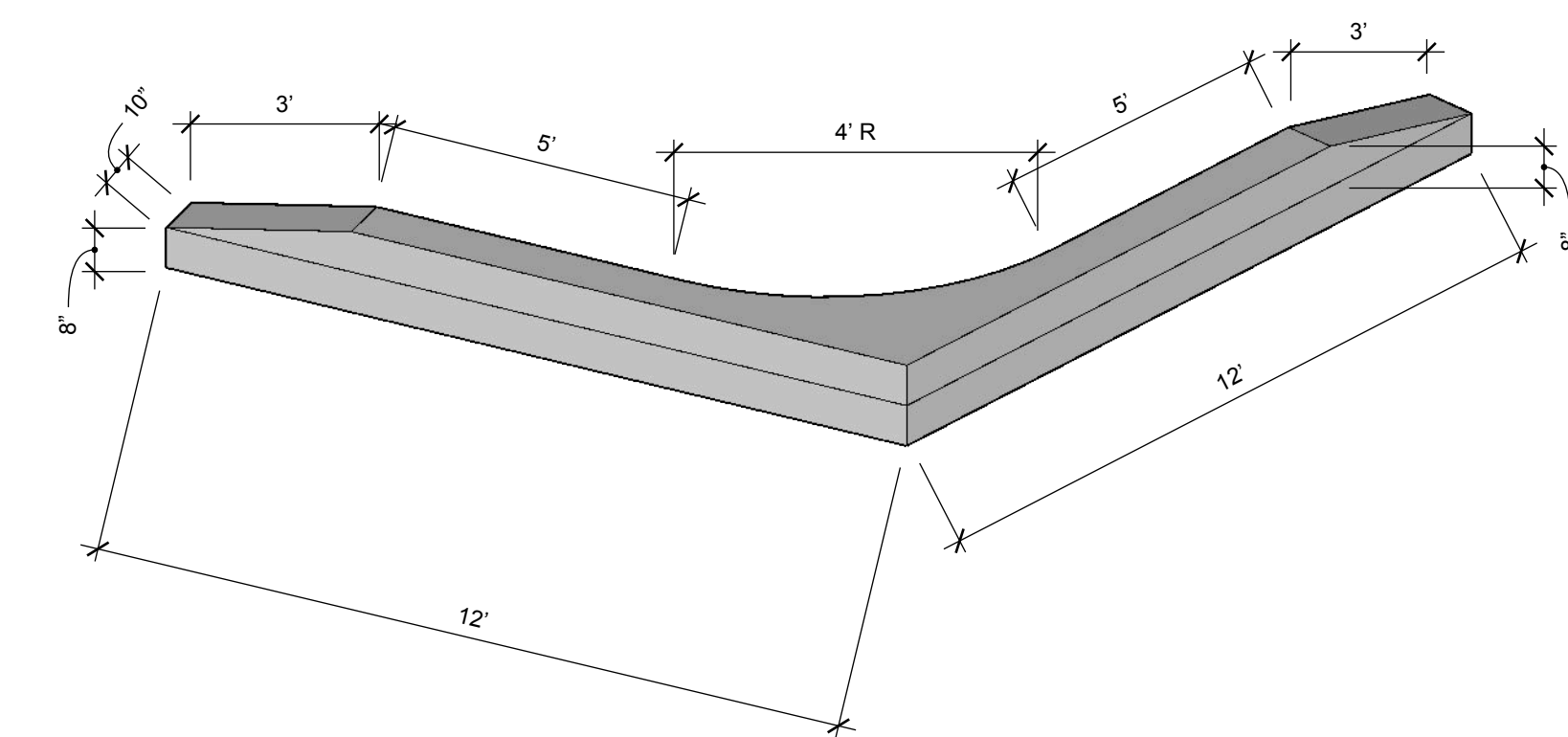

FRONT FACE OF CURB TO BE FORMED WITH STRAIGHT FORMS, REAR TO BE FORMED USING STRAIGHT AND FLEX FORMS. EDGES OF EXPOSED CONCRETE TO BE EDGED USING 1/2" EDGING TOOL. FACES ARE TO BE RUBBED WITH A SPONGE. AS NOTED IN DRAWING THERE IS TO BE AN 8" EXPOSED FACE. TOP OF CURB TAPERS IN 3' TO MEET SLAB GRADE. \*CURB POURED BEFORE BANK AND TOP SLAB. \*PROPER CONSOLIDATION OF SLAB AND BANK CONCRETE IS ESSENTIAL WHERE MEETING CURB.

\*FEATURES ARE NOT TO SCALE

- A- RADIUS CURB 1
- E- HUBBA/FLAT LEDGE
- F- FLAT BAR/DOWN RAIL
- H- TIER LEDGE
- I- BOX LEDGE
- K- RADIUS CURB 2

P3- LEDGE, RAIL DETAIL



COMPANY:  
Arment Concrete  
PO Box 43 DENVER, PA  
MATT@ARMENTCONCRETE.COM

CLIENT  
CARLISLE BOROUGH  
53 W. SOUTH STREET  
CARLISLE PA 17013

ISSUE  
12/20/2021

PROJECT NO.  
1/1/22-01

PROJECT  
Carlisle Skatepark

ENGINEER:  
FREDERICK SEIBERT &  
ASSOCIATES, INC.  
128 S POTOMAC ST  
HAGERSTOWN, MD 21740  
(301) 791-3650





\*ALL PERIMETER DECK TO SLOPE 2% AWAY FROM BOWL COPING

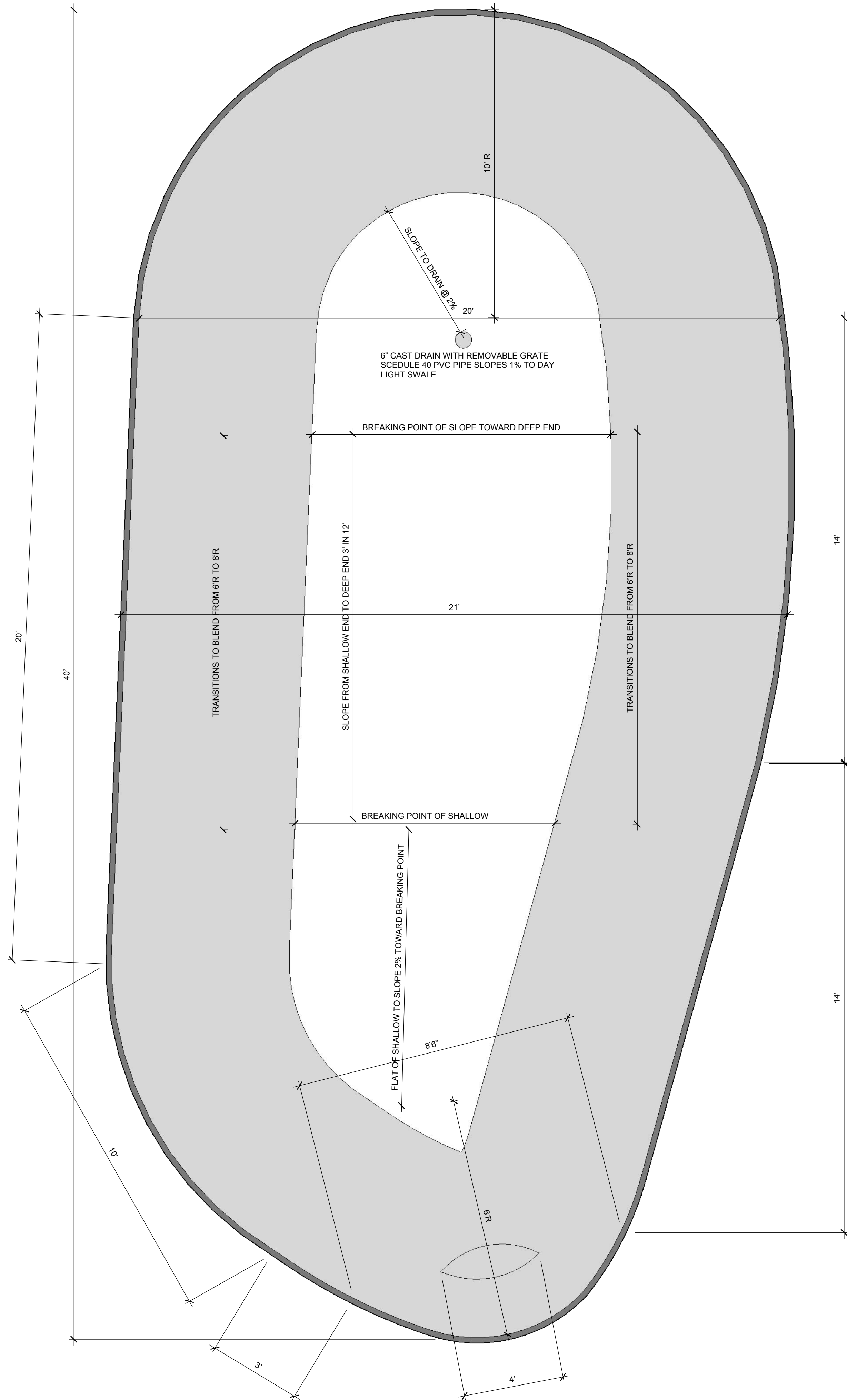

\*SCALE OF BOWL DRAWING IS 1/2" PER 1'

DEEP END DETAIL

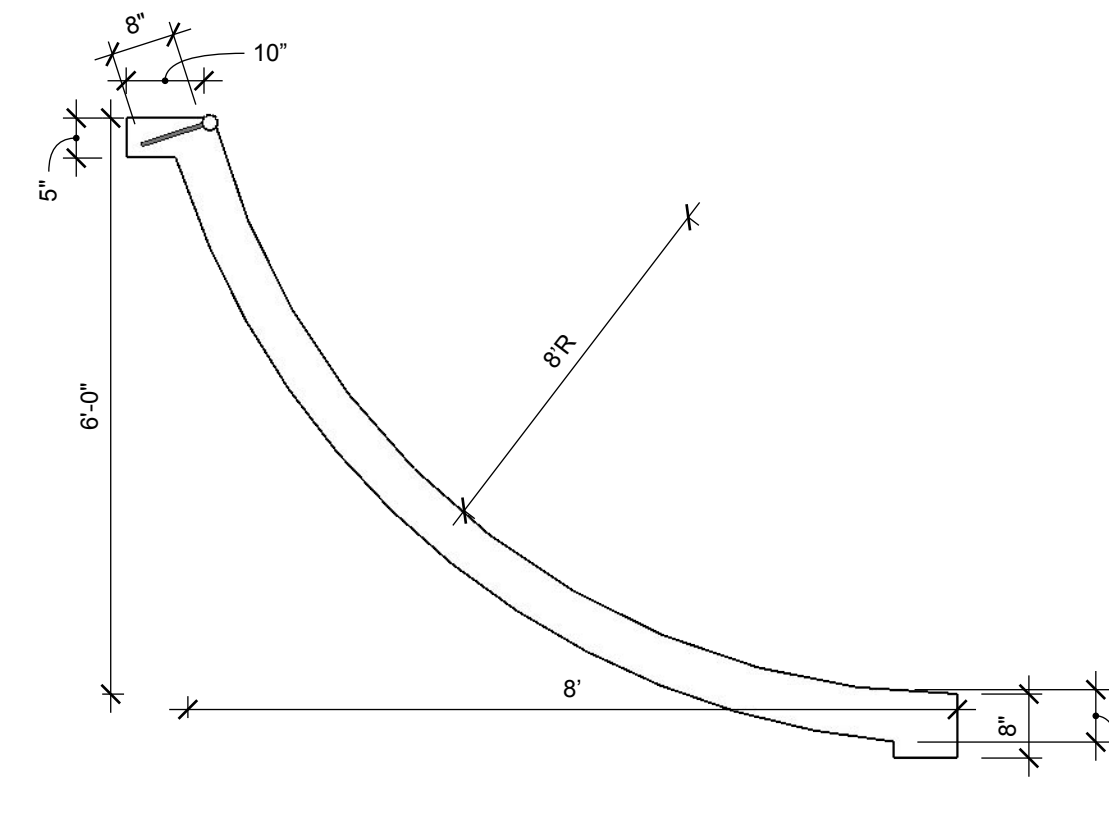

SHALLOW END DETAIL

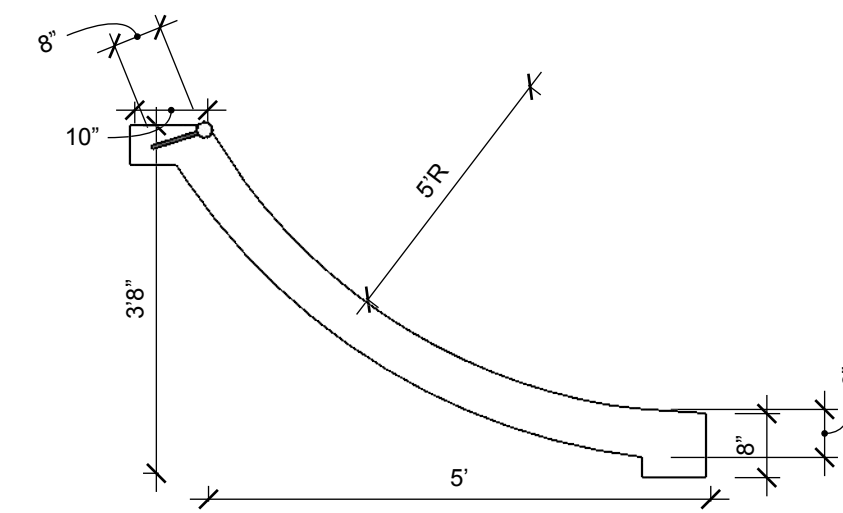

LOVE SEAT DETAIL

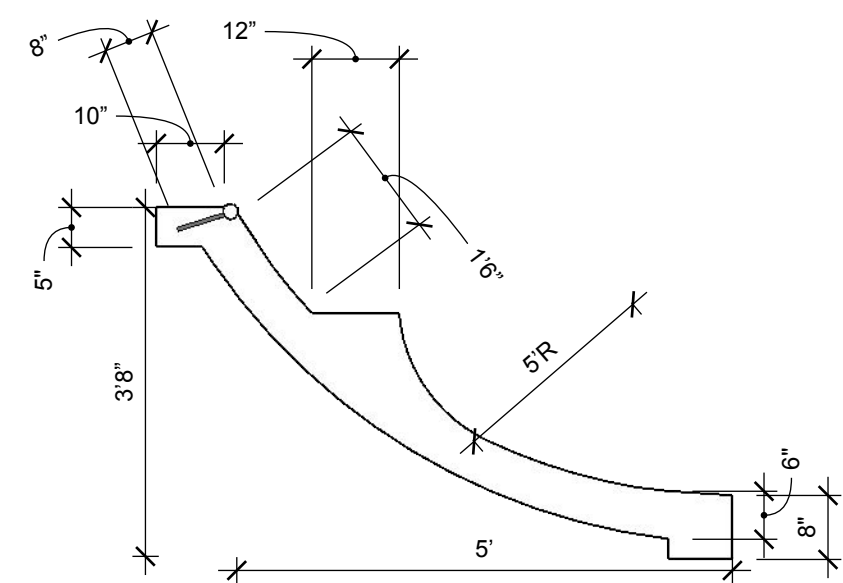

COPING DETAIL

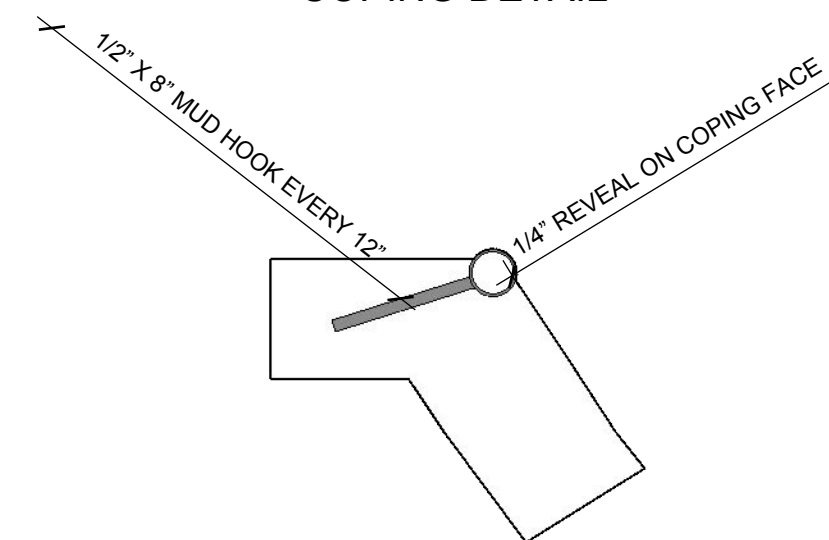

GENERAL NOTES:

DUE TO ORGANIC SHAPE OF BOWL, COPING RADIUS AND BLENDS TO BE FIELD VERIFIED. SEAMS OF COPING PIPE TO BE WELDED, GROUND SMOOTH AND PRIMED. MUD HOOKS TO BE WELDED TO COPING PIPE AS SHOWN IN DRAWING, TO BE IMBEDDED IN DECK CONCRETE AT ANGLE TO NOT ALLOW STEEL TO BE EXPOSED. DISTANCE FROM COPING TO BOTTOM COLD JOINT AT FLAT BOTTOM WILL VARY AND SHOULD BE DETERMINED SO THAT THE RADIUS OF TRANSITION FORMS TANGENT BLEND INTO THE FLAT BOTTOM. IF COLD JOINTS ARE NECESSARY IN TRANSITION POURS, THEY SHALL BE PLACED IN FLAT OR MILD WALLS, NOT IN CORNERS OF BOWL POCKETS. LOVE SEAT TO BE POURED AS SHOWN AND IS IN GENERAL A MEANS TO GET OUT OF THE BOWL AND A FEATURE TO RIDE OVER OR AROUND. BANK SLOPES WILL VARY DEPENDING ON AREA AND ELEVATION DIFFERENCE. A 4' RADIUS SHOULD BE USED AT BANK'S BOTTOM SLOPE WHERE IT MEETS FLAT BOTTOM.

\*SPECIFICATIONS FROM PAGE ONE SHALL APPLY TO ALL CONCRETE.

BANK DETAIL (SHOWN IS AREA BY "K" RADIUS CURB 2)

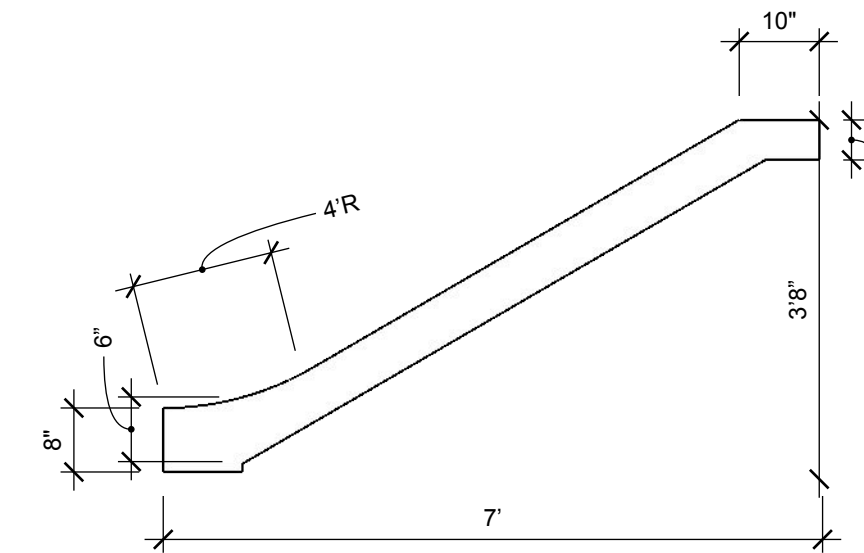

COMPANY:  
Arment Concrete  
PO Box 43 DENVER, PA  
MATT@ARMENTCONCRETE.COM

CLIENT  
CARLISLE BOROUGH  
53 W. SOUTH STREET  
CARLISLE PA 17013

ISSUE  
12/20/2021

PROJECT NO.  
1/1/22-01

PROJECT  
Carlisle Skatepark

ENGINEER:  
FREDERICK, SEIBERT &  
ASSOCIATES, INC.  
128 S POTOMAC ST  
HAGERSTOWN, MD 21740  
(301) 791-3650





COMPANY:  
Arment Concrete  
PO Box 43 DENVER, PA  
MATT@ARMENTCONCRETE.COM

CLIENT  
CARLISLE BOROUGH  
53 W. SOUTH STREET  
CARLISLE PA 17013

ISSUE  
12/20/2021

PROJECT NO.  
1/1/22-01

PROJECT  
Carlisle Skatepark

ENGINEER:  
FREDERICK, SEIBERT &  
ASSOCIATES, INC.  
128 S POTOMAC ST  
HAGERSTOWN, MD 21740  
(301) 791-3650



\*SCALE= 1/2" PER 1'

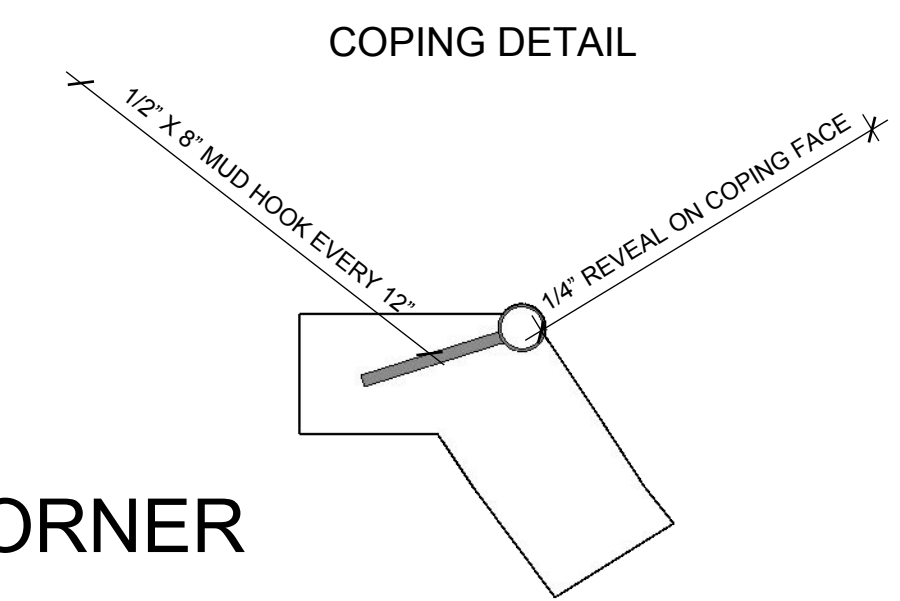
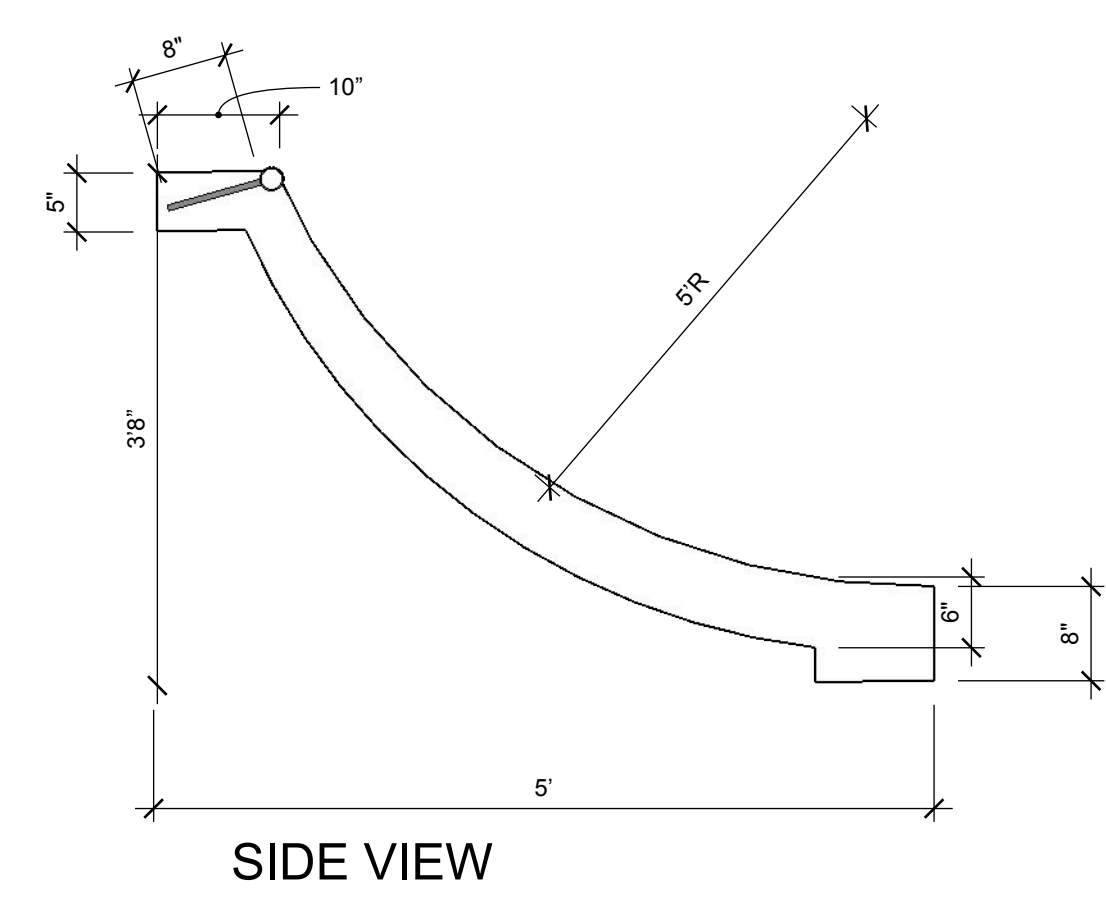
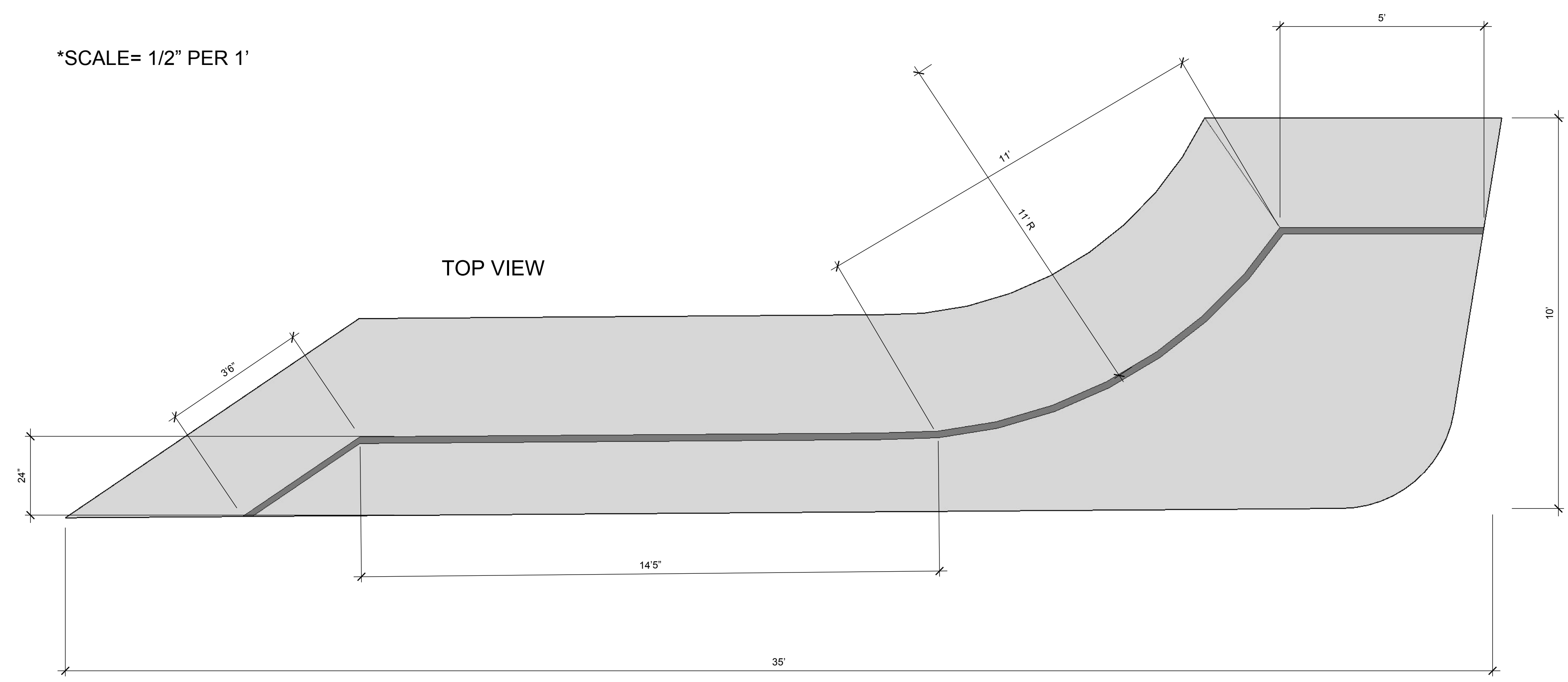

SIDE VIEW: PERIMETER WALL

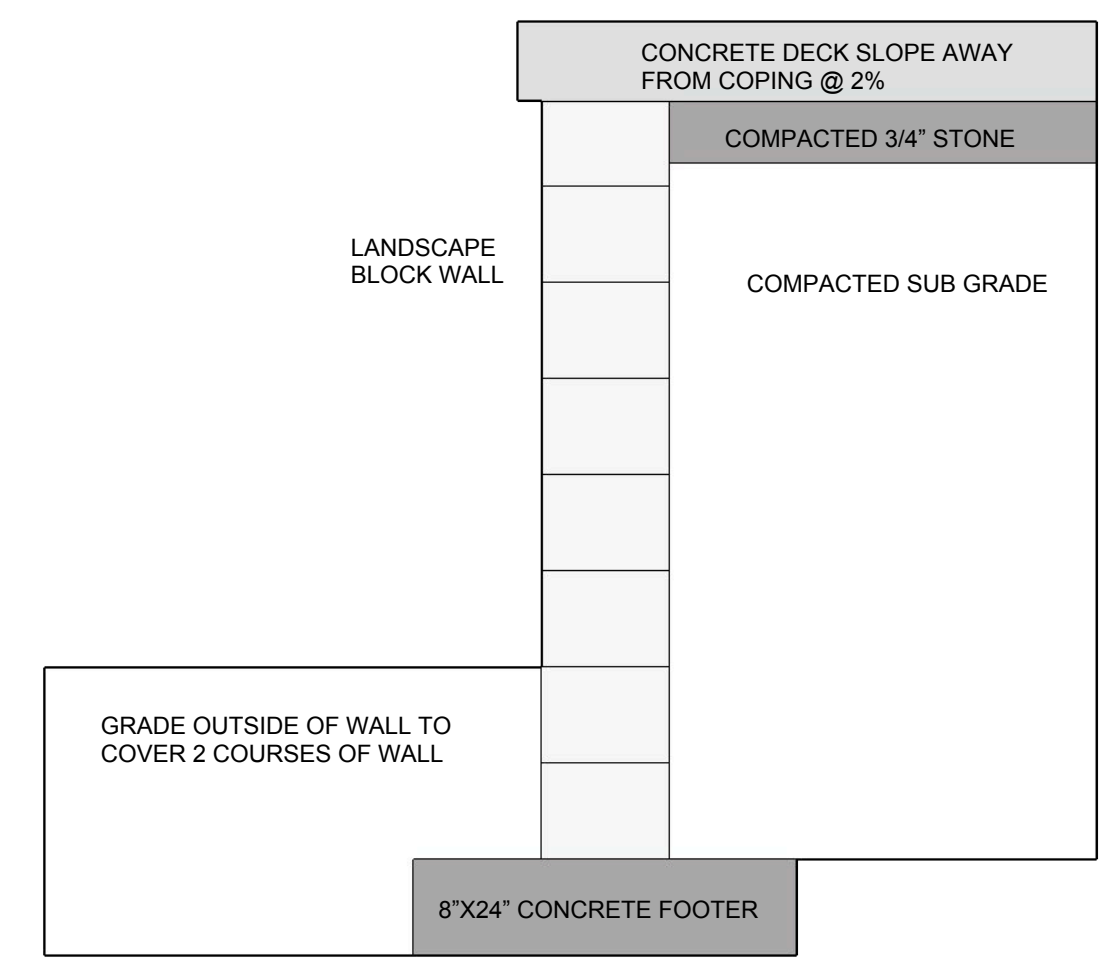

**PERIMETER WALL/DECK**

GENERAL NOTES:  
VERSALOC BRAND OR SIMILAR LANDSCAPE BLOCK TO BE USED WHERE GRADING REQUIRES. CONCRETE DECK TO REST ON TOP OF WALL, NOT ANCHORED, WITH 1.5" REVEAL. ALL CONCRETE DECKS TO SLOPE @ 2% AWAY FROM COPING, AND Poured ON 4" CLEAN COMPACTED 3/4" STONE. ALL COLD JOINTS MUST HAVE 1/2" X 18" REBAR DOWELS EVERY 12".

**QUARTERPIPE W/ BOWL CORNER**

GENERAL NOTES:  
COPING RADIUS AND BLENDS TO BE FIELD VERIFIED. SEAMS OF COPING PIPE TO BE WELDED, GROUND SMOOTH AND PRIMED. MUD HOOKS TO BE WELDED TO COPING PIPE AS SHOWN IN DRAWING, TO BE IMBEDDED IN DECK CONCRETE AT ANGLE TO NOT ALLOW STEEL TO BE EXPOSED. DISTANCE FROM COPING TO BOTTOM COLD JOINT AT FLAT BOTTOM WILL VARY AND SHOULD BE DETERMINED SO THAT THE RADIUS OF TRANSITION FORMS TANGENT BLEND INTO THE FLAT BOTTOM. IF COLD JOINTS ARE NECESSARY IN TRANSITION POURS, THEY SHALL BE PLACED IN FLAT OR MILD WALLS, NOT IN CORNERS OF BOWL POCKETS. RADIUS SHOULD BE USED AT BANK'S BOTTOM SLOPE WHERE IT MEETS FLAT BOTTOM.

\*SPECIFICATIONS FROM PAGE ONE SHALL APPLY TO ALL CONCRETE.



**COLD JOINT DETAIL**

TOP OF COLD JOINTS TO BE FINISHED FLUSH. GRINDING MAY BE NECESSARY IN SOME CASES TO MAKE THE AREAS AS SEAMLESS AS POSSIBLE. CO-JOINED SLABS SHOULD BE THICKENED TO 8" IN A 10" SPAN. 1/2" X 18" SMOOTH DOWEL REBAR TO BE EVERY 12". EXPANSION JOINTS TO BE CUT EVERY 200 SQUARE FEET WHERE APPLICABLE.

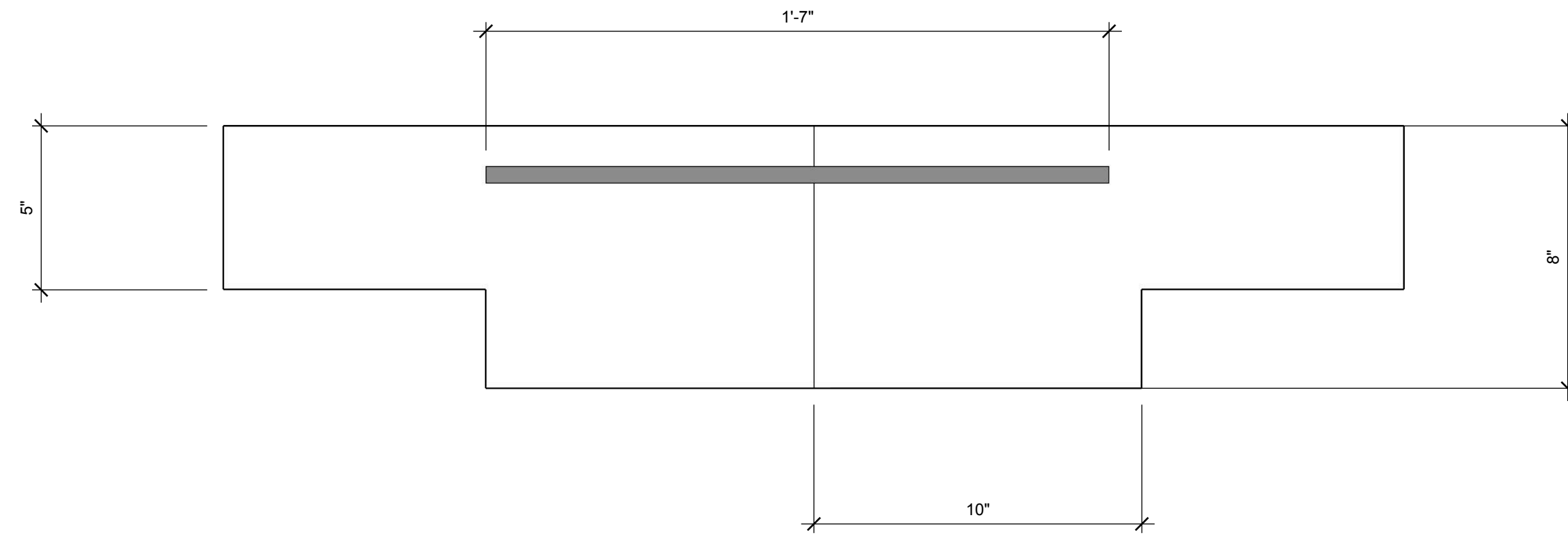

**REBAR SCHEDULE:**

ALL TRANSITIONAL FEATURES IN PARK TO HAVE 12"X12" GRID OF 3/8" REBAR TIED AT EVERY INTERSECTION WITH WIRE TIES. THIS REBAR CAGE IS TO BE 3" UNDER FINISHED CONCRETE SURFACE. REBAR TO BE TIED OR WELDED TO COPING MUD HOOKS AND LEDGE STEEL.

ALL FLAT/ DECK AREAS IN PARK TO HAVE 24"X24" GRID OF 3/8" REBAR TIED AT EVERY INTERSECTION WITH WIRE TIES. THIS CAGE IS TO BE 3" UNDER FINISHED CONCRETE SURFACE.

**FENCING:**

BARRIER FENCING MUST BE IN PLACE AT ALL TIMES DURING CONSTRUCTION AND PROPER SIGNAGE TO KEEP PEDESTRIANS CLEAR OF JOB SITE. FENCING WILL REMAIN UNTIL BOROUGH ACCEPTS TOTAL RESPONSIBILITY OF THE LOT.

**SIGNAGE:**

PROPER SIGNAGE DISPLAYING RULES, REGULATIONS AND PARK HOURS WILL BE THE RESPONSIBILITY OF CARLISLE BOROUGH AND PUT IN PLACE BEFORE PUBLIC USE OF THIS SKATEPARK FACILITY.

**DRAIN DETAIL**

ON GRADE FLOOR DRAIN WITH BRASS OR STAINLESS REMOVABLE GRATE. 4" DRAIN CONNECT TO 4" SCHEDULE 40 PVC PIPE AND RAN TO DAYLIGHT STORM DRAIN AT 1% SLOPE.



**842-36PNR**



**COMPANY:**  
Arment Concrete  
PO Box 43 DENVER, PA  
MATT@ARMENTCONCRETE.COM

**CLIENT**  
CARLISLE BOROUGH  
53 W. SOUTH STREET  
CARLISLE PA 17013

**ISSUE**  
12/20/2021

**PROJECT NO.**  
1/1/22-01

**PROJECT**  
Carlisle Skatepark

**ENGINEER:**  
FREDERICK, SEIBERT &  
ASSOCIATES, INC.  
128 S POTOMAC ST  
HAGERSTOWN, MD 21740  
(301) 791-3650

